



From: Planning Department

December 15, 2009

Subject: On Board Imager (OBI) Upgrade Memo

The following information should be reviewed with the Customer that is planning to upgrade their existing Clinac or Silhouette Edition Clinac with an On Board Imager (OBI).

Do not proceed to download an Installation Data Package until the serial number of the Varian Clinac, to be upgraded, has been confirmed with the Customer.

- ALL Clinac 2100, 21EX, 2300, and 23EX with the following serial numbers and **BELOW** will receive/use dedicated hardware only:

21XX - #2799 and below

23XX - # 499 and below

Download the "**Dedicated Hardware - Clinac On Board Imager (OBI) upgrade**" from this web page. (cut and paste this address)

http://www.varian.com/media/oncology/services_and_support/download/OBI-Clinac_dedicated_hardware.pdf

- ALL 2100, 21EX, 2300, 23EX and iX with the following serial numbers and **ABOVE** will receive/use integrated hardware only:

21XX - #2800 and above

23XX - # 500 and above

All Silhouette Edition Clinacs

All iX Models and Trilogy Clinacs

Download the "**Integrated Hardware – Clinac and Silhouette - On Board Imager (OBI) upgrade**" from this web page. (cut and paste this address)

http://www.varian.com/media/oncology/services_and_support/download/OBI-Clinac_integrated_hardware.pdf

For assistance or questions, contact your Varian Planning Representative from this web page-
http://www.varian.com/us/oncology/services_and_support/architectural_planning/contact.html

Varian Medical Systems
Planning Department
660 N. McCarthy Boulevard, MS-OS207
Milpitas, CA 95035
Direct - 408-232-4231
Fax - 408-232-4230
800-278-2747
Email: planning@varian.com

Clinac On-Board Imager (OBI) Dedicated Hardware Upgrade

Clinac 2100, 21EX serial number 2799 and below. Clinac 2300, 23EX serial number 499 and below.

DETAIL "A"

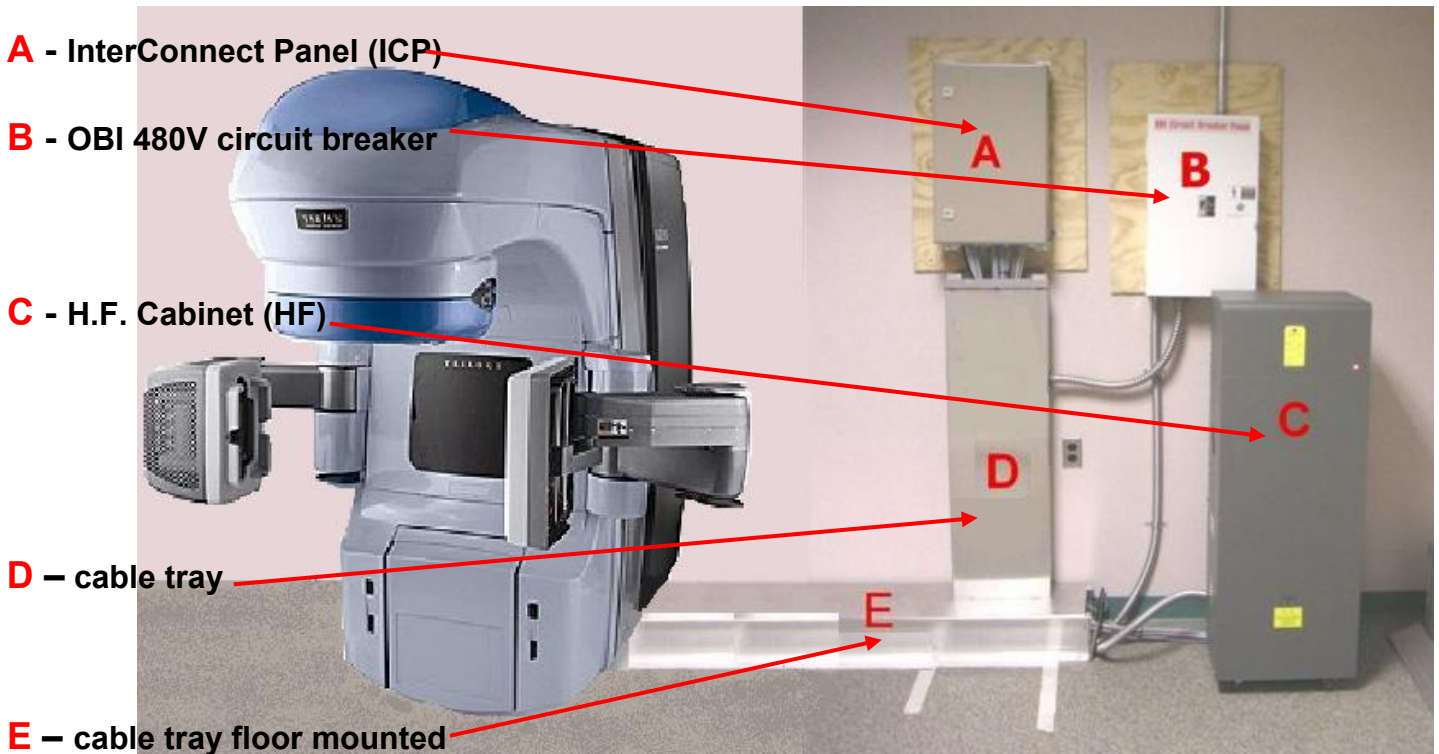

- A** - The InterConnect Panel (ICP) is installed inside of the treatment room as shown. It can be located on either side of the Clinac, usually the opposite side from the modulator cabinet.
- B** - The OBI 480V circuit breaker can be installed inside of the treatment room as shown. It can be located on either side of the Clinac, usually the opposite side from the modulator cabinet. The OBI 480V circuit breaker can be installed at the control console. The 480V circuit breaker panel can be flush mounted as shown or recessed into the wall. The power conduits can be flush mounted as shown or recessed into the wall. Terminate the conduit and wiring from the output of the 480V circuit breaker at the H.F. Cabinet (**C**).
- C** - The H.F. Cabinet (HF) is installed inside of the treatment room. (It is shown moved for clarity. Tape on floor is normal location.)
- D** - The cable tray is installed to the wall studs to just below the ICP.
- E** - The cable tray can be installed flat onto the floor (detail A) or flat against the wall (detail B).

Do Not locate **A, B, C**, within the primary beam path of the Clinac.

Clinac On-Board Imager (OBI) Dedicated Hardware Upgrade

DETAIL "B"

A - InterConnect Panel (ICP)

B - OBI 480V circuit breaker

D - Cable tray (behind HF)

C - H.F. Cabinet (HF)

E - cable tray wall mounted

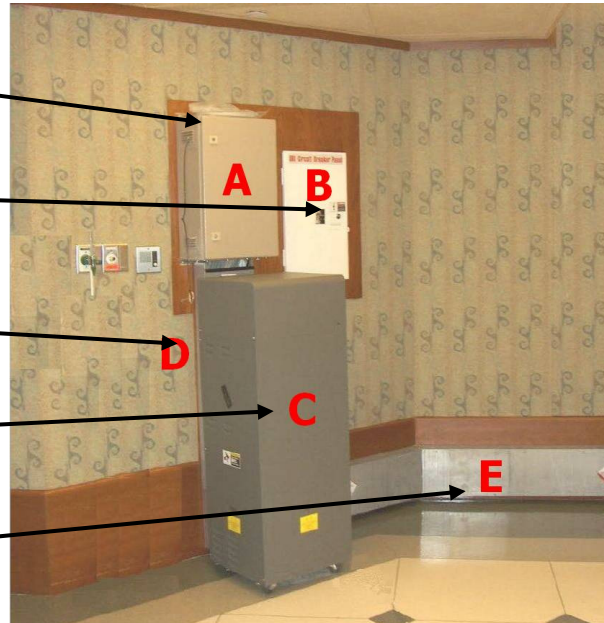

Do not locate **A, B, C**, within the primary beam path of the Clinac.

DETAIL "B"

E - cable tray shown wall mounted

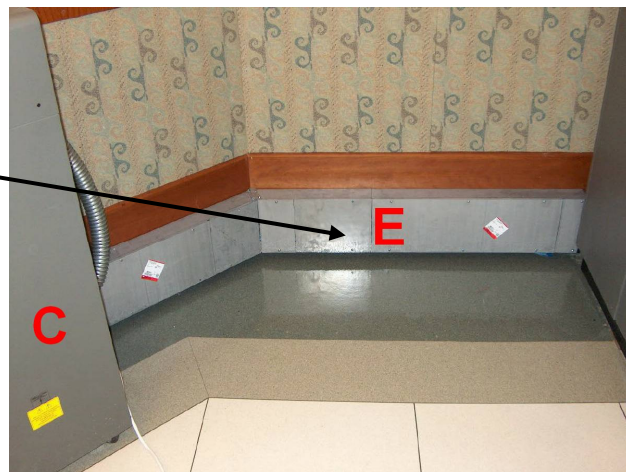

Clinac On-Board Imager (OBI) Integrated Hardware Upgrade

Clinac 2100, 21EX serial number 2800 and above. Clinac 2300, 23EX serial number 500 and above.
All iX and Trilogy Clinacs.

DETAIL "A"

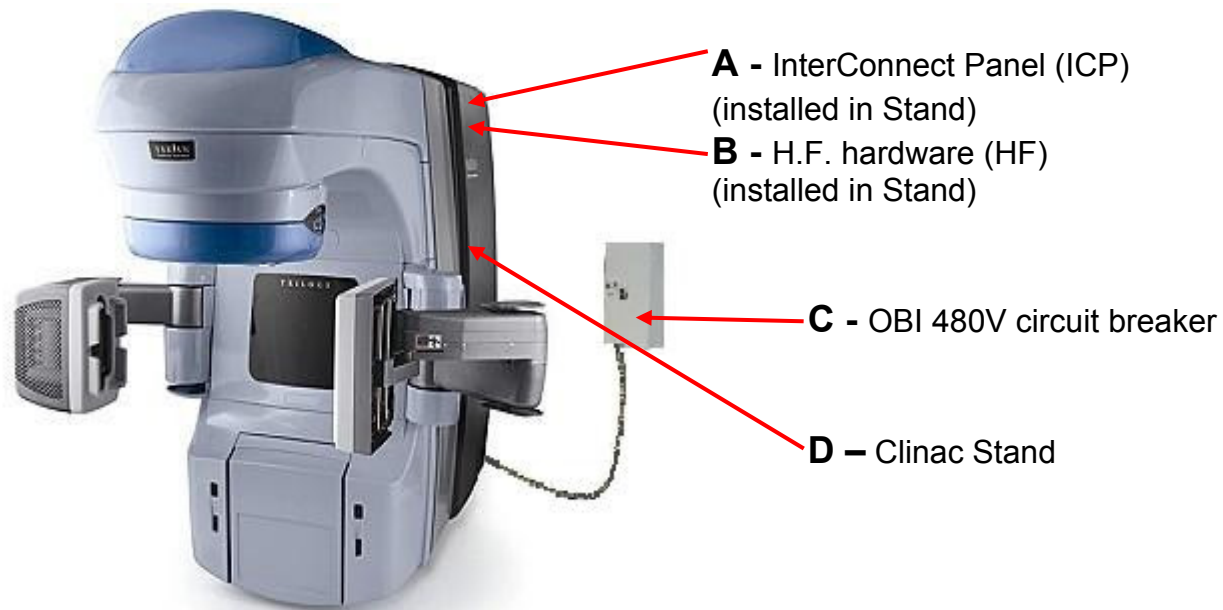

A - The InterConnect Panel (ICP) is installed inside of the Clinac Stand.

B - The H.F. hardware (HF) is installed inside of the Clinac Stand.

C - The OBI 480V circuit breaker can be installed inside of the treatment room as shown. It can be located on either side of the Clinac, usually the opposite side from the modulator cabinet. Do not locate "**C**" within the primary beam path of the Clinac
The OBI 480V circuit breaker can be installed at the control console.
The 480V circuit breaker panel can be flush mounted as shown or recessed into the wall. The power conduits can be flush mounted as shown or recessed into the wall. Terminate the conduit and wiring from the output of the 480V circuit breaker into the Clinac Stand (**D**).

D - Clinac Stand, Gantry and On Board Imager (OBI)

Silhouette On-Board Imager (OBI) Hardware Upgrade

Applies to ALL Silhouette Edition Clinacs (2100, 21EX, 2300, 23EX, All iX and Trilogy Clinacs).

A - InterConnect Panel (ICP)

B - H.F. Hardware shelf

DETAIL "A"

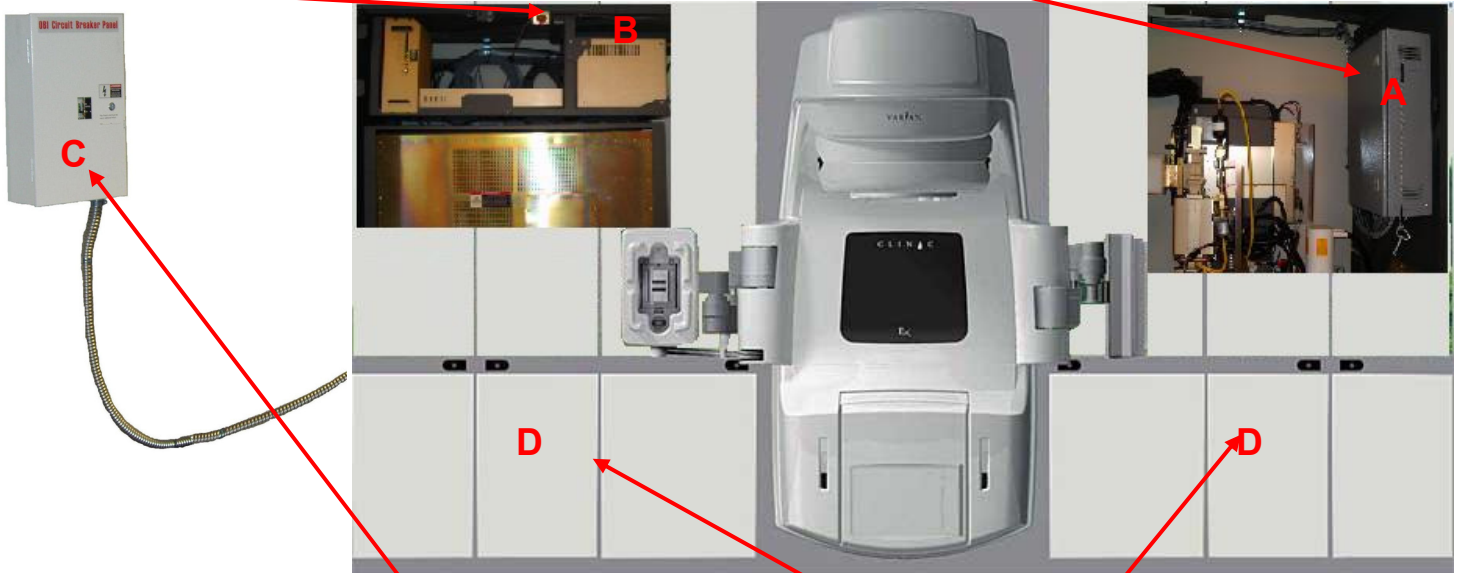

C - OBI 480V circuit breaker

D –Silhouette cabinet has doors that conceal the internal hardware.

A - The InterConnect Panel (ICP) is installed inside of the Silhouette cabinet as shown.

B - The H.F. Hardware (HF) is installed inside of the Silhouette cabinet as shown.

C - The OBI 480V circuit breaker can be installed inside of the treatment room as shown. It can be located on either side of the Silhouette cabinet. Do not locate “**C**” within the primary beam. The OBI 480V circuit breaker can be installed at the control console. The 480V circuit breaker panel can be flush mounted as shown or recessed into the wall. The power conduits can be flush mounted as shown or recessed into the wall. Terminate the conduit and wiring from the output of the 480V circuit breaker into the Silhouette cabinet (**D**).

D – The Silhouette cabinet is assembled around the equipment and contains the hardware behind access doors.